

PDA PAV

PDA COLUMN TO FLOOR FIXING KIT

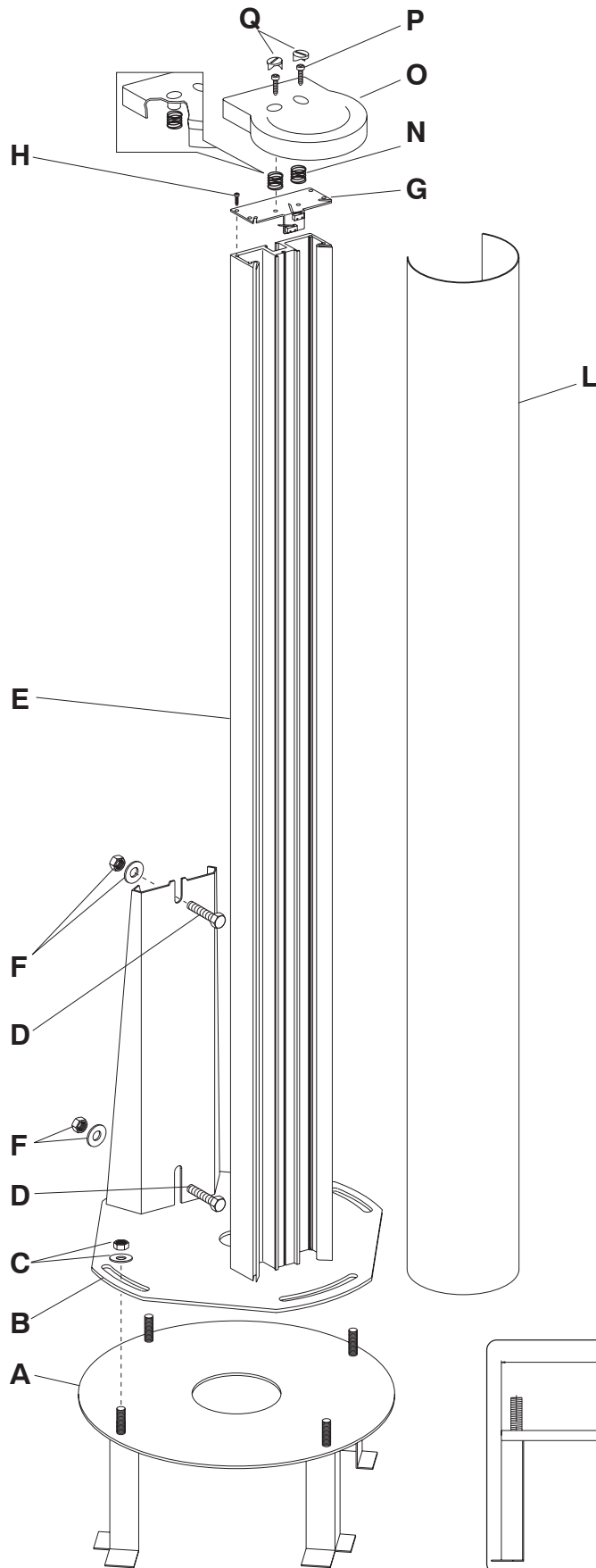

ASSEMBLY INSTRUCTIONS

- 1 - Cast enough concrete over the lower plate anchor brackets **A** so as to fully submerge them, taking care to perfectly level and smooth out the concrete so as to bring it flush with plate which must emerge from the concrete plinth.
- 2 - Wait until the cement is completely set.
- 3 - Place the column base **B** onto the plate **A** and fix with the special nuts and washers **C**, without fully tightening, to allow final adjustments during the photocell aligning phase.
- 4 - Insert the screws **D** in the rear channel of the column **E**.
- 5 - Rest the column **E** on the shoulder of the base plate **B**, insert the bolts in the special slots and block them with nuts and washers **F**.
- 6 - Fix the upper foolproof plate (with the 2 microswitches) **G** with the special screws **H**.
- 7 - Assemble the photocell units.
- 8 - Align the photocells as illustrated in the specific instructions.
- 9 - Tighten the base plate **B** stop nuts **C**.
- 10 - Insert the polycarbonate cover **L** on to the external guides of the column.
- 11 - Rest the two springs **N** on the upper foolproof plate **G**, in correspondence with the two central holes, and insert the upper cover **O**, making sure that the two springs are inserted in the two cups underneath.
- 12 - Secure the upper cover **O** with the two special screws **P**, without tightening completely, leaving about 3-4mm of play to help the spring operation.
- 13 - Close the two upper holes of the cover with the special plugs **Q**.