

PDA STAF

PDA COLUMN WALL FIXING KIT

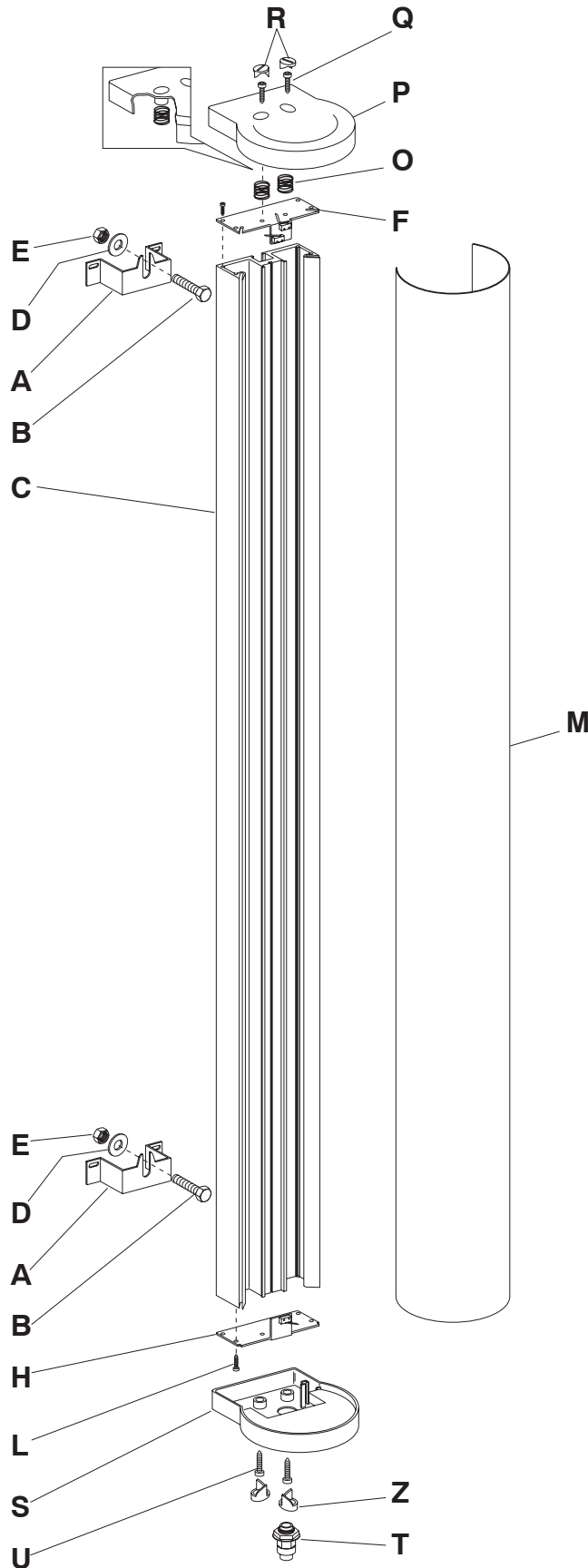

ASSEMBLY INSTRUCTIONS

- 1 - Fix the two brackets **A** to the wall (with suitable plugs for the structure of the wall), ensuring that they are perfectly aligned. Pay attention to the slot on the brackets that must always have the open part upwards.
- 2 - Insert the screws **B** into the rear channel on the column **C**, fit in the washers **D** and tighten the nuts **E**, leaving enough space to fit the column onto the wall bracket.
- 3 - Position the column at the desired height and tighten the two nuts **E** onto the brackets **A**.
- 4 - Fix the upper foolproof plate (with the 2 microswitches) **F** with the special screws **G**.
- 5 - Fix the lower foolproof plate (with one microswitch) **H** with the special screws **L**.
- 6 - Install the photocell units.
- 7 - Align the photocells as instructed.
- 8 - Slide the polycarbonate cover **M** into the external column guides. .
- 9 - Rest the two springs **O** on the upper foolproof plate **F** in correspondence with the two central holes, and slide on the upper cover **P** , making sure that the springs are inserted in the two cups underneath.
- 10 - Secure the upper cover **P** with the two special screws **Q**, without excessively tightening, so that there is 3-4mm of play to help the spring operation.
- 11 - Close the two upper holes on the cover with the special plugs **R**
- 12 - Screw the special watertight fairlead **T** onto the lower cover **S**
- 13 - Slide on the lower cover **S** fixing with the two special screws **U**
- 14 - Close the two lower holes of the cover **S** with the plugs **Z**.